

# 1x2 Single Mode Mechanical Optic Switch

## Features

- Unmatched Low Cost
- Low Insertion Loss
- High Channel Isolation
- Highly Stable and Reliable
- Epoxy-Free Optical Path



## Applications:

- The light signal top/bottom road
- System monitoring
- Instrument equipment
- Light signal routing

Performance index and specification:

| Parameters                                      | Specifications         |         |         |                |
|---|------------------------|---------|---------|----------------|
|   | 1260~1360 or 1510~1610 |         |         | 1310/1550 ± 40 |
| Operating wavelength (nm)                       |                        |         |         |                |
| Insertion loss (dB)                             | P grade                | A grade | P grade | A grade        |
|   |                        | < 0.6   | < 0.8   | < 0.7          |
|   |                        |         |         | < 1.0          |
| Wavelength dependant loss (WDL) (dB)            | ≤ 0.25                 | ≤ 0.25  | ≤ 0.25  | ≤ 0.30         |
| Polarization dependant loss(PDL) (dB)           | ≤ 0.05                 | ≤ 0.05  | ≤ 0.05  | ≤ 0.05         |
| Temperature dependant loss(TDL)(dB)             | < 0.15                 | < 0.20  | < 0.15  | < 0.20         |
| Cross talk (dB)                                 | >55                    | >55     | >55     | >55            |
| Durability (dB)                                 | < ± 0.02               |         |         |                |
| Return loss (dB)                                | > 55                   |         |         |                |
| Switching time (ms)                             | <10 (Typ.4)            |         |         |                |
| Coil resistance (Lead Angle 1-5 or 6-10) (ohms) | 178 ± 10%              |         |         |                |
| Operating voltage(V)                            | 3 or 5                 |         |         |                |
| Maximum power load (mW)                         | 500                    |         |         |                |
| Durability (cycle )                             | >10 million            |         |         |                |
| Operating temperature (° C)                     | 0 ~ +70                |         |         |                |
| Storage temperature (° C)                       | -45 ~ +85              |         |         |                |
| Fiber type                                      | SMF-28                 |         |         |                |
| Fiber length (m)                                | 1.0 +/- 0.1            |         |         |                |
| Dimension (LxWxH) (mm)                          | 23×11.5×13.6           |         |         |                |

Insertion loss is not within connector.

Electronic pins structure:

| Parameter                    | Typical | Minimum | Maximum | Unit |
|------------------------------|---------|---------|---------|------|
| Optic switch working voltage | 5       | 4       | 6       | V    |
| Optic switch work current    | 30      |         |         | mA   |
| Pulse width                  | >50     |         |         | ms   |

Dimensions:

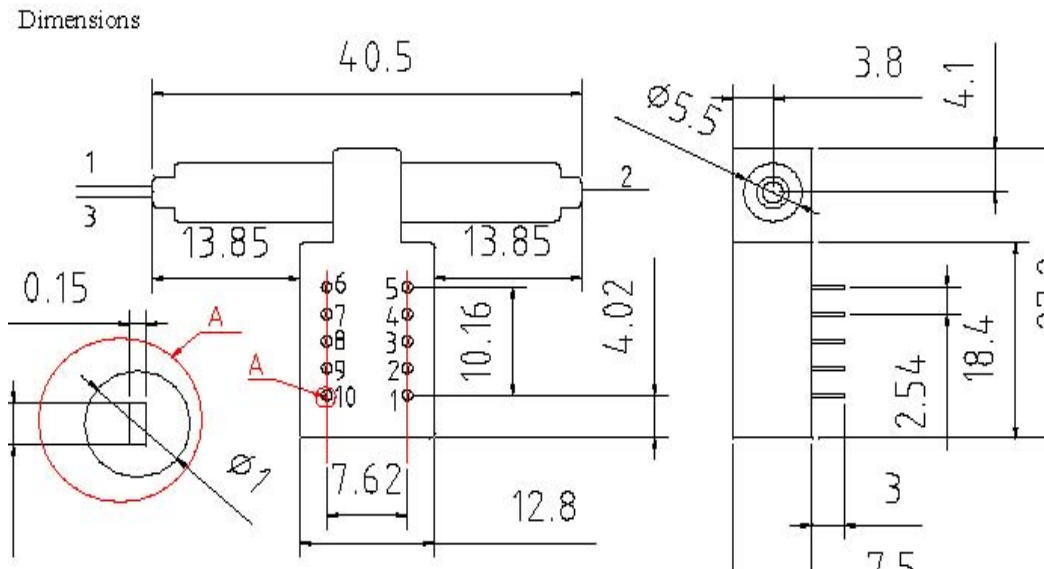

Ordering information:

| Type | Condition                    | Operating wavelength                           | Port   | Grade                  | Fiber type                     | Fiber length           | In/Out connector type  |
|------|------------------------------|--|--|------------------------|--------------------------------|------------------------|--|
| SMS  | 1=non-latching<br>2=latching | 15=1550±40nm<br>13=1310±40nm<br>35=1310/1550nm | 0102=1x2<br>0104=1x4<br>0108=1x8<br>01016=1x16<br>01032=1x32<br>01064=1x64<br>0100=other | 1=P grade<br>2=A grade | 1=Bare Fiber<br>2=900um Jacket | 1=1 Meter<br>2=2 Meter | 1=None<br>2=FC/APC<br>3=FC/PC<br>4=SC/APC<br>5=SC/PC<br>6=ST<br>7=LC |